

Gaumer Connection Kits

Installation Instructions

GB300-L-G / GB300-L-R

On-Pipe Lighted End Seal

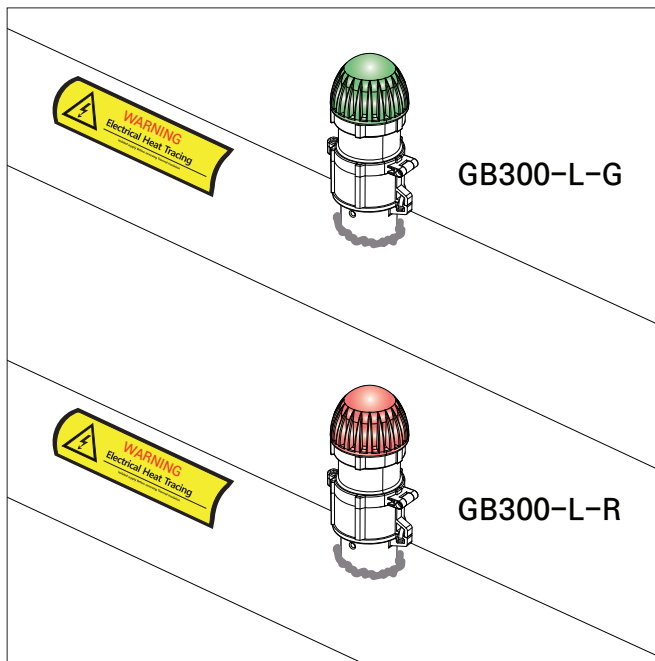

Description

- GB300-L is an above insulation lighted end seal kit for use with GAUMER GHT-CR, GHT-CT, GHU-CT and GHK-CT self-regulating heating cables.
- GB300-L can be used to terminate Gaumer heating cables with red or green light indicator.
- Light indicator is available in green or red.
- Operating voltage from 100 to 240Vac.

Catalog number designation

GB300 – L – □

└ G : Green Light Indicator

R : Red Light Indicator

Approvals

「 GB300-L-G / GB300-L-R 」

[US, CANADA]

Hazardous (classified) locations, indoors and outdoors

Class I, Division 2, Groups A, B, C and D T*;

Class II/III, Division 2, Groups E, F and G T*;

Class I, Zone 1, AEx/Ex eb mb IIC T* Gb

Zone 21, AEx/Ex tb IIIC T* °C Db

Type 4X, IP66

Ta = -40°C to +55°C

[ATEX, IECEx]

⚡ II 2 G Ex eb mb IIC T* Gb;

⚡ II 2 D Ex tb IIIC T* °C Db

Ex eb mb IIC T* Gb;

Ex tb IIIC T* °C Db

Ta = -40°C to +55°C IP66

- T* = For T-rating, please refer to cable documentation.
- [Note] US, Canada, ATEX, and IECEx Certificate Pending

Kit Contents

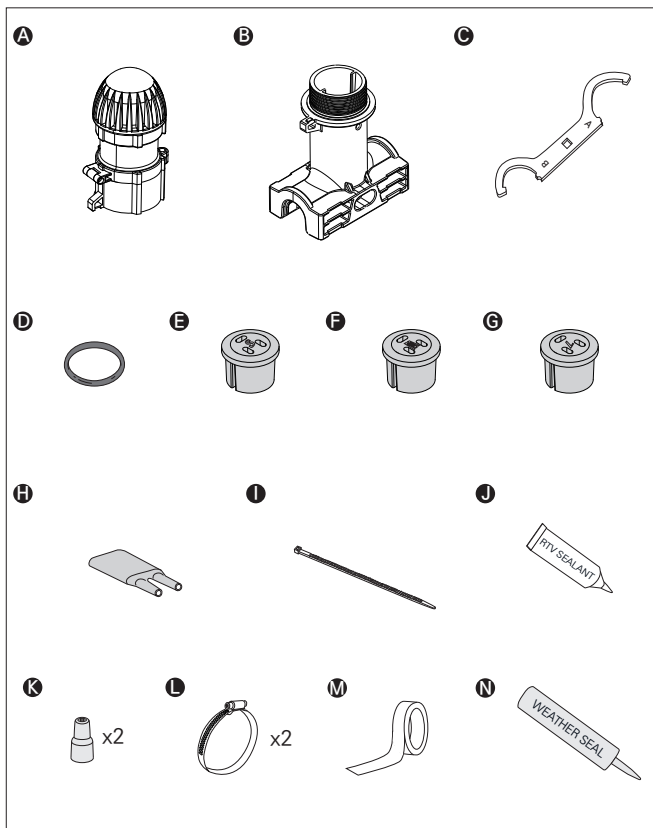

Item	Description	Qty.
A	Lighted End Cap	1
B	Pipe Stand	1
C	Wrench	1
D	Stand O-ring	1
E	S Grommet for GHU-CT, GHT-CT	1
F	M Grommet for GHT-CR	1
G	L Grommet for GHK-CT	1
H	Core Sealer(S)	1
I	Cable Tie	1
J	RTV Sealant	1
K	Closed End Connector	2
L	Pipe Strap (Sold Separately)	2
M	Fixing Tape (Sold Separately)	1
N	Weather Seal (Sold Separately)	1

Tools Required

- Wire cutters
- Marking pen
- Adjustable pliers
- Needle nose pliers
- Utility knife
- Large slotted screwdriver
- Molex RHT-7000 crimp tool or equivalent; 10-16AWG slot

Additional Materials Required

- Pipe Straps

Model	Pipe Size	Unit Qty.
GPS-SS02	Up to 2" Outer Diameter	2ea / bag
GPS-SS05	2" to 5" Outer Diameter	2ea / bag
GPS-SS10	5" to 10" Outer Diameter	2ea / bag
GPS-SS18	10" to 18" Outer Diameter	2ea / bag
GPS-SS24	18" to 24" Outer Diameter	2ea / bag

- Small Pipe Adapter

For installation on small pipes ($\leq 1"$ or 25mm diameter), contact Gaumer Process for small pipe adapter, GSPA.

- Fixing Tapes

- GFT-L98 : Fiberglass Tape low temp; 1/2" * 98ft (30m)
- GFT-H98 : Fiberglass Tape high temp; 1/2" * 98ft (30m)
- GAT2/3-L164 : Aluminum tape low temp;
2" or 3" * 164ft (50m)

- Pipe Stand Extension

For installation with insulation thicker than 3" (76mm), or on very hot pipe, contact Gaumer Process for pipe stand extension, GPSE.

CAUTION

- The minimum installation temperature is -40°F (-40°). For more convenient installation, we recommend performing the installation at a temperature above freezing. Store the kit at a temperature above freezing until installation.

WARNING

- Gaumer heat-tracing systems must be installed correctly to ensure proper operation and to prevent shocks and fires. Pay attention to warnings and carefully follow applicable installation instructions.
- For two or more heating cables powered by a single circuit, the total length of all heating cables should not exceed the maximum circuit length allowed in the chart published in the Gaumer self-regulating heating cables datasheets or design guide. Additionally, the total current of all heating cables should not surpass 80% of the circuit breaker rating.
- **Electrical Shock or Fire Hazard :** Follow Gaumer requirements and comply with NEC, CEC, and all relevant local codes. **Ground-fault equipment protection** set at 30 mA must be used on each heating cable branch circuit. Arcing may not be stopped by conventional circuit breakers.
- The approvals and performance of the heat tracing systems are based exclusively on the use of Gaumer specified parts. It is imperative that parts are not substituted and electrical tape is not used.
- Damaged bus wires have the potential to overheat or cause short circuits. When scoring the jacket or core, it is essential to avoid breaking the bus wire strands.
- Both components and cable ends must be kept dry before and throughout the installation process.
- The potential for bus wires to overheat or short circuit exists if the bus wire strands are broken while preparing the cable for connection. Reuse of grommets or use of the wrong

grommet can result in leaks, cracked components, shocks, or fires. Ensure the type or opening size of grommet is correct for the heating cable being installed. A new grommet is recommended whenever the cable has been pulled out of the component.

- Before and during installation or servicing, all power circuits must be de-energized.
- Read the MSDS for RTV and components carefully.
- Use thermal insulation and attachment tape suitable for the specific application and heat-tracing temperature. Do not secure heating cables with metal straps or wire, as this may damage the cables.

Specific Conditions of Use

- Gaumer GB300-L Series Connection Kits must be installed using Gaumer GHT, GHU, GHK Series Heating Cables.
- Refer to the installation instructions to reduce the potential of an electrostatic charging hazard on the enclosures of the connection kits.
- The end-user shall mount the equipment per Gaumer instructions.

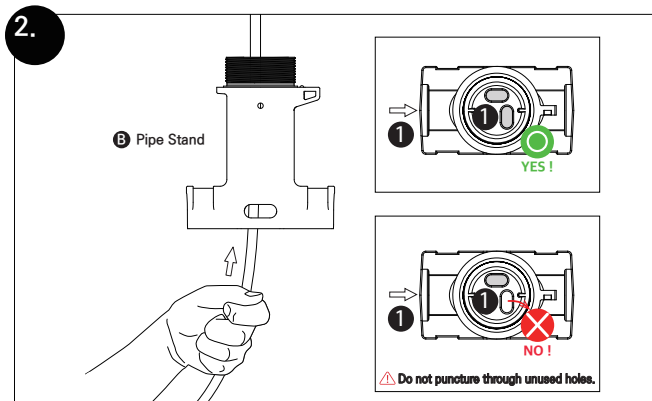
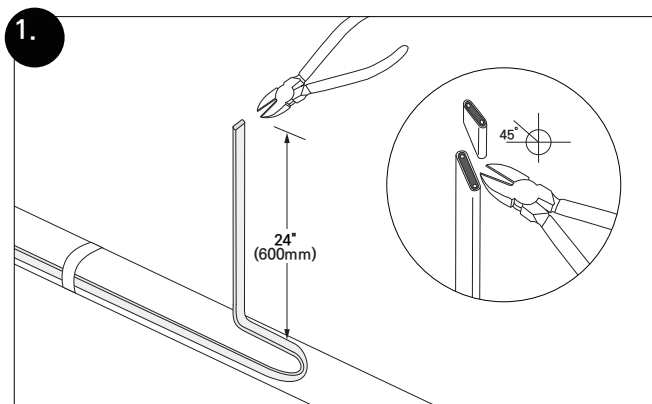

3.

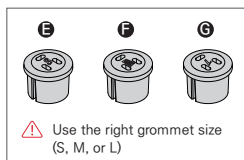
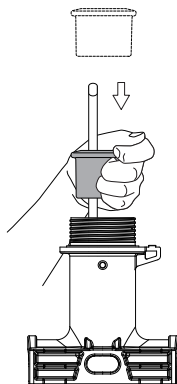

4.

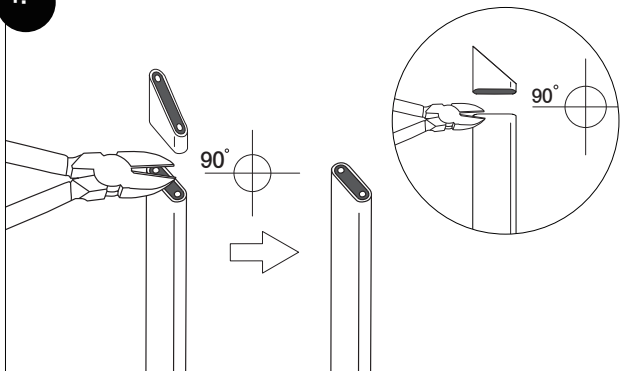

5.

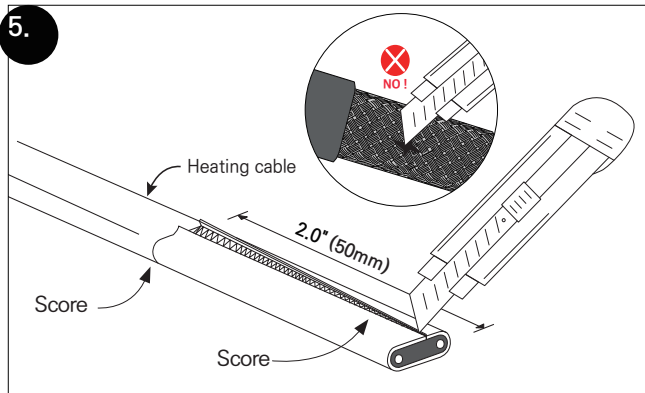

6.

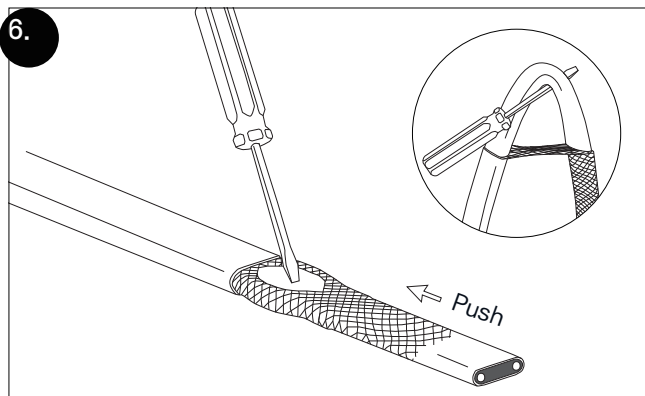

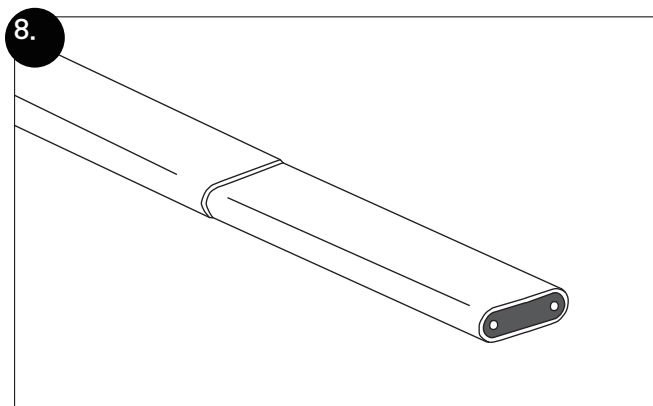
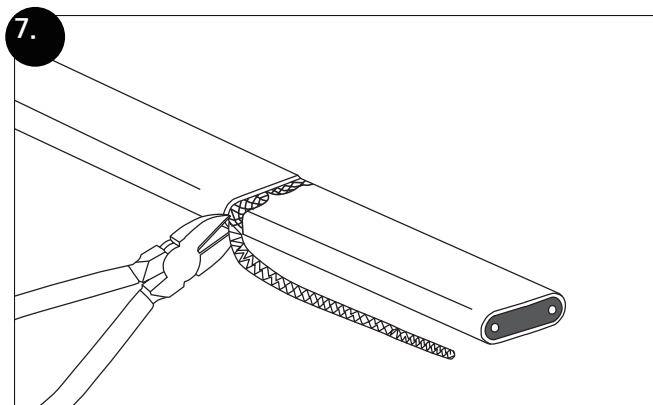

9.

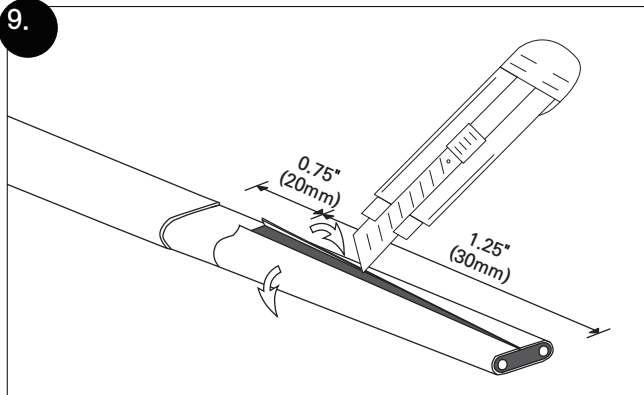

10.

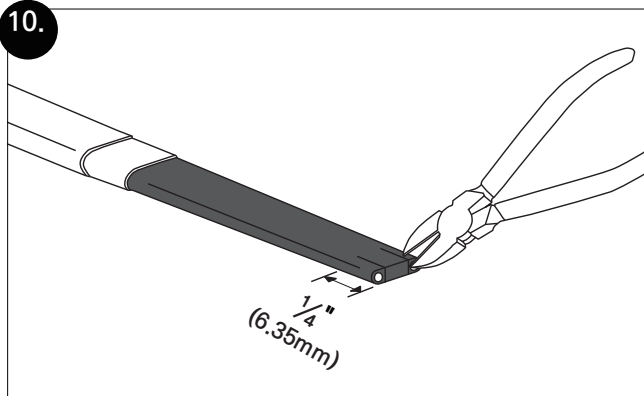

11.

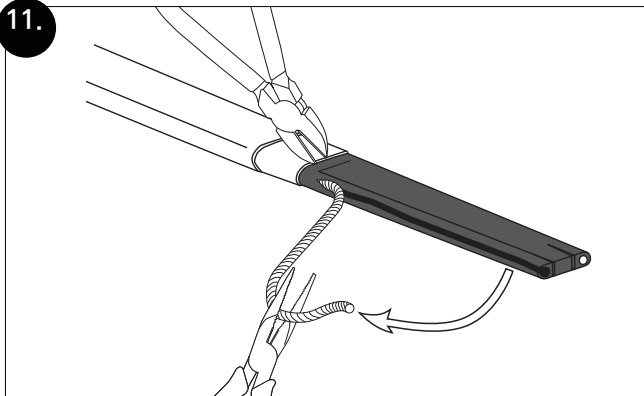

12.

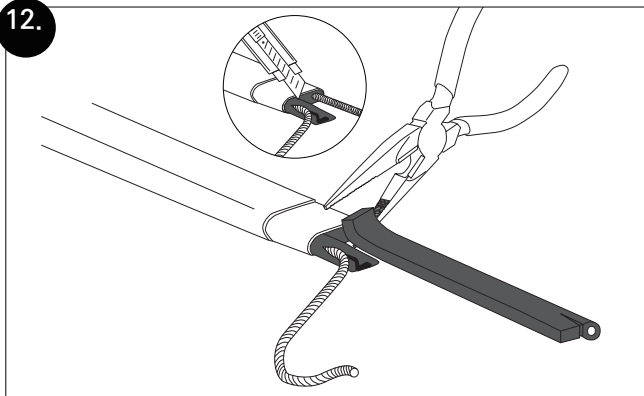

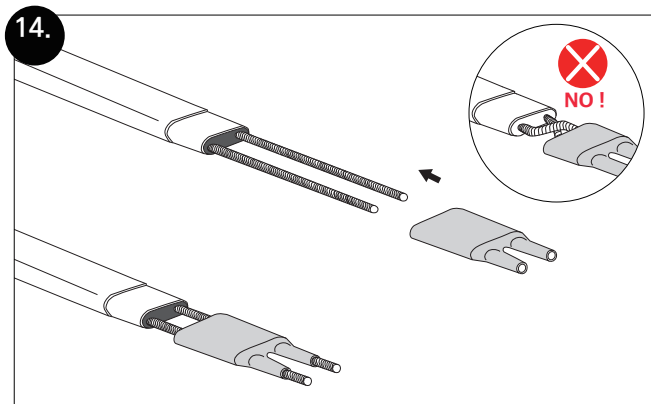
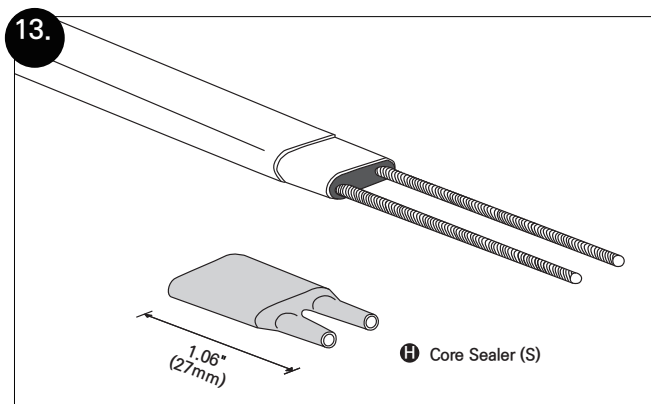

15.

J RTV Sealant

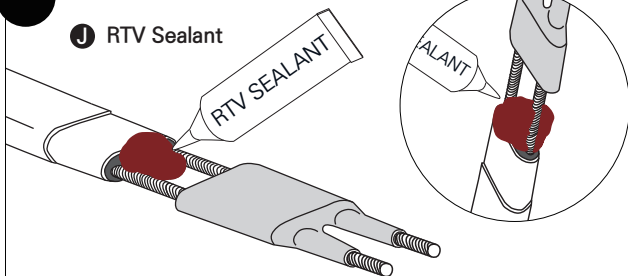

Apply extra RTV for GHU-CT due to its smaller dimensions to ensure proper sealing.

16.

H Core Sealer

Front view



"Push to open round and let RTV in"

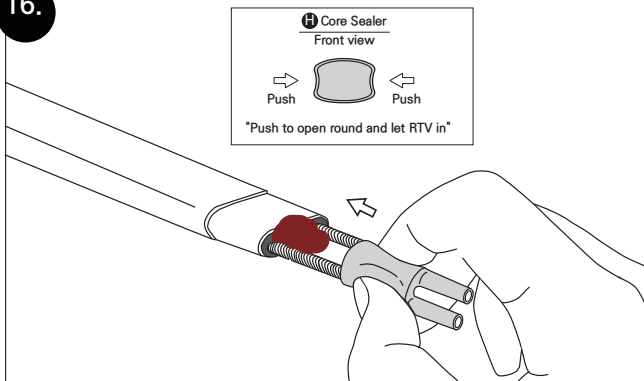

17.

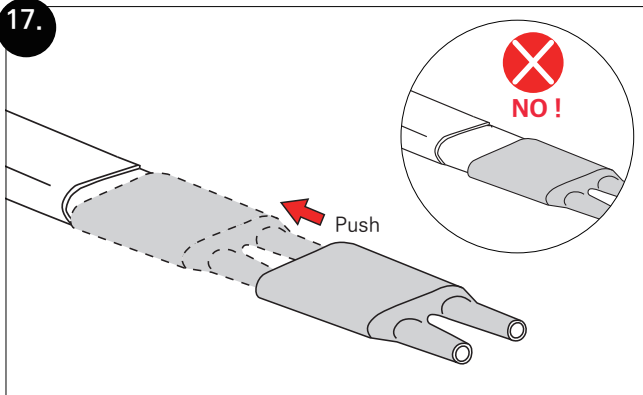

18.

NOTE : RTV Sealant should ooze out around the core sealer.

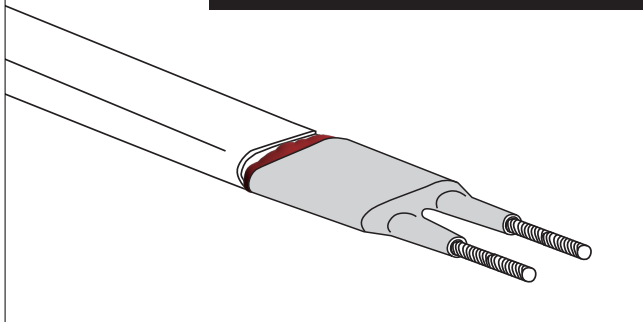

19.

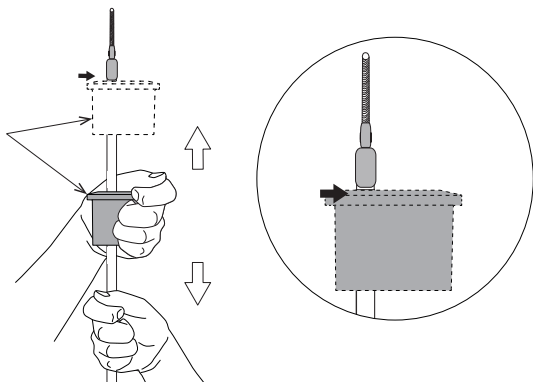

20.

Use two Pipe Straps (L)
of the same size to match
the pipe diameter.
Pipe straps sold separately.

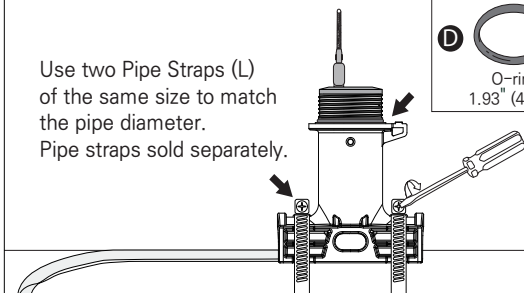
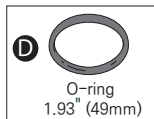

21.

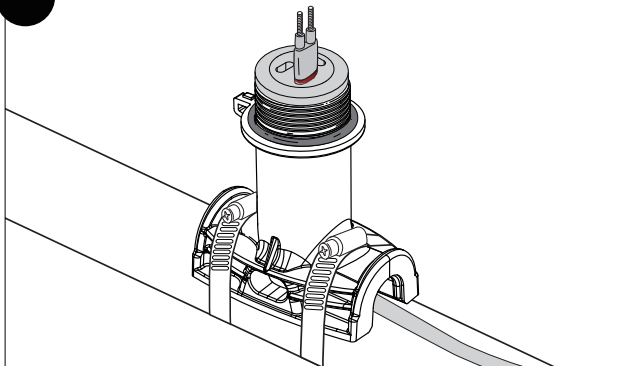

22.

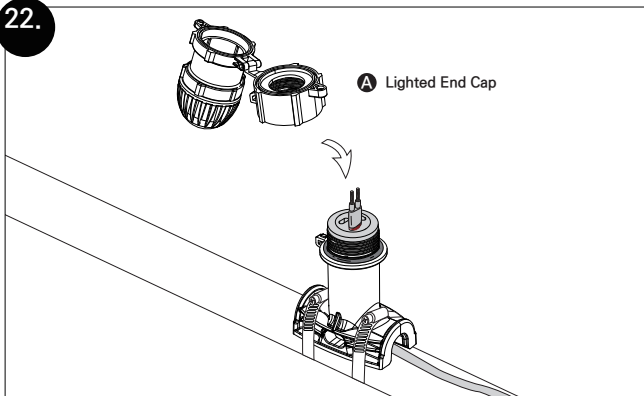

23.

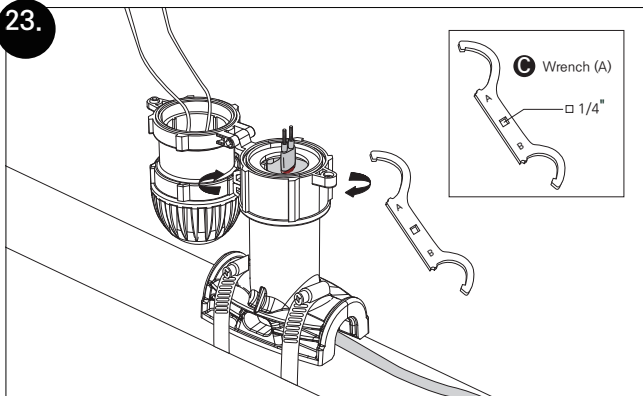

24.

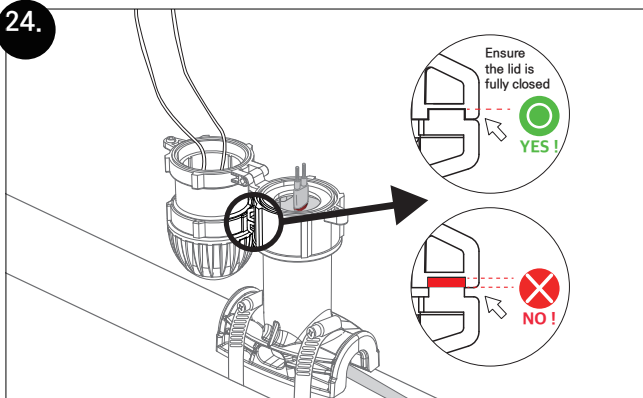

25.

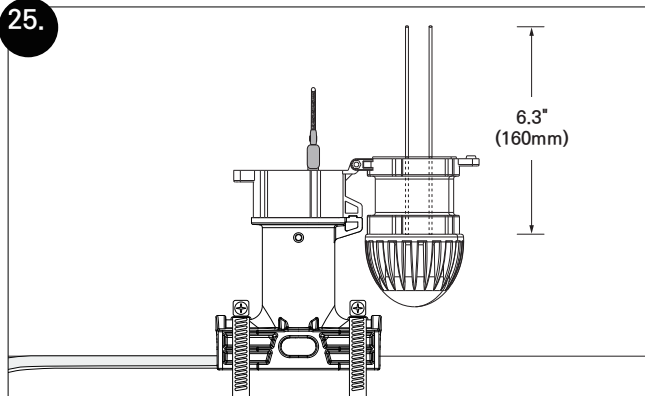

26.

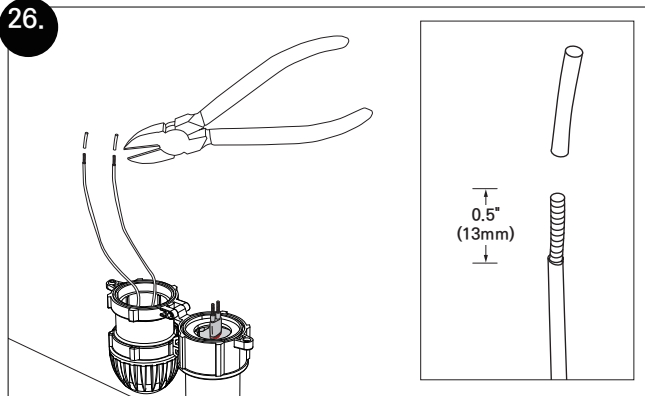

27.

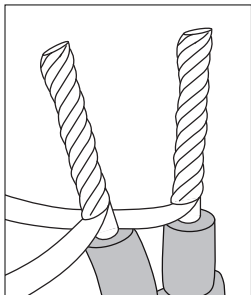
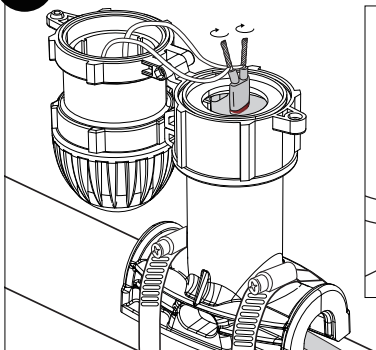

28.

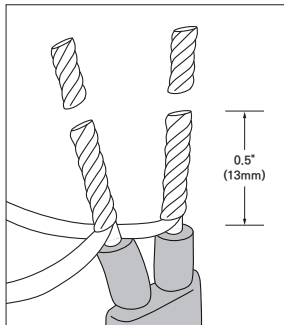
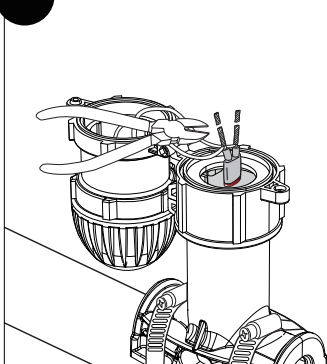

29.

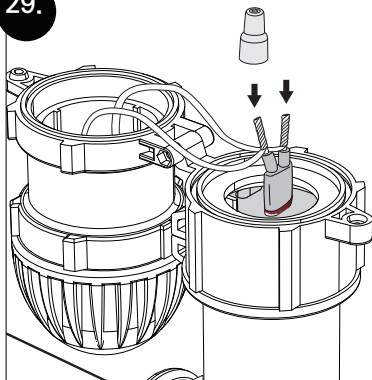

K



x2

Closed End Connector

30.

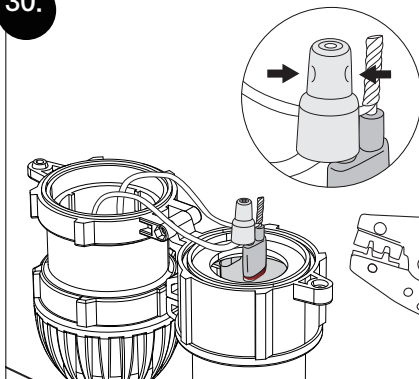

Insert pre-twisted wires
into connector and crimp.

31.

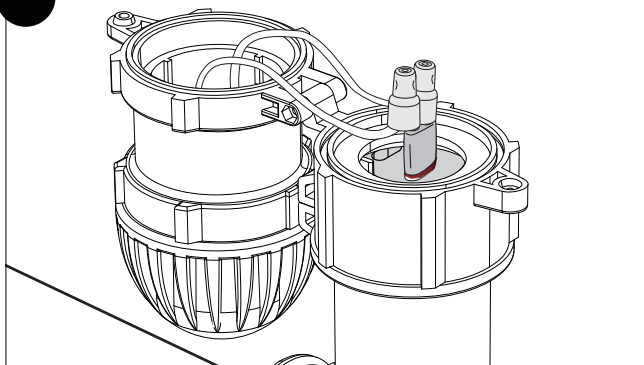

32.

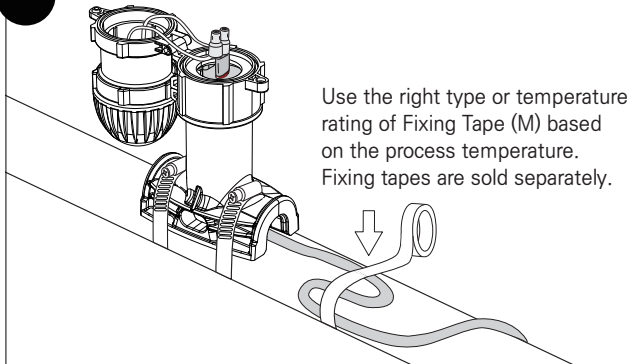

33.

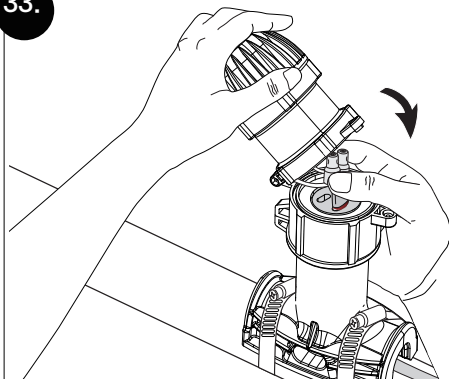

34.



Ensure wires are not caught between the cap and compression cap.

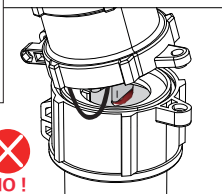
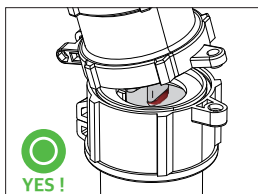

35.

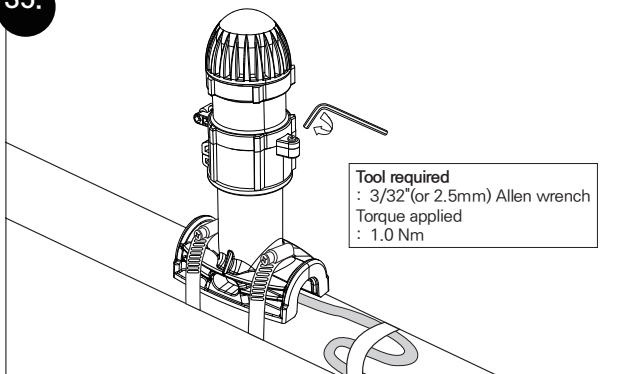

36.

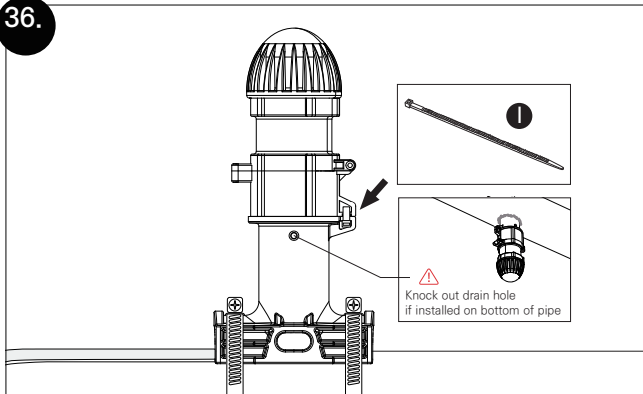

37.

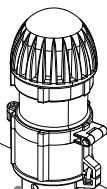

ⓘ Weather seal



Gaumer Process

ADDRESS 13616 Hempstead Road · Houston, TX, U.S.A., 77040

WEB www.gaumer.com **TEL** +1 (800) 460 5200 **E-MAIL** sales@gaumer.com